

# Boomsma Tract 2 N 1/2 Soils Map

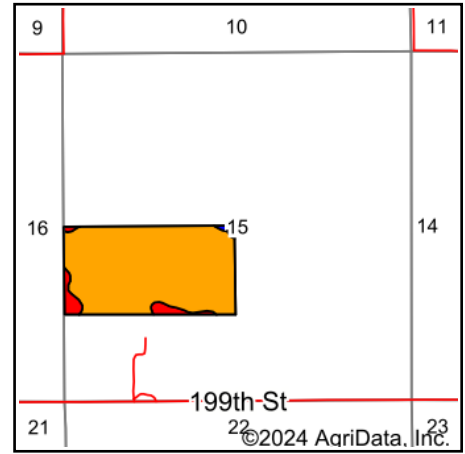

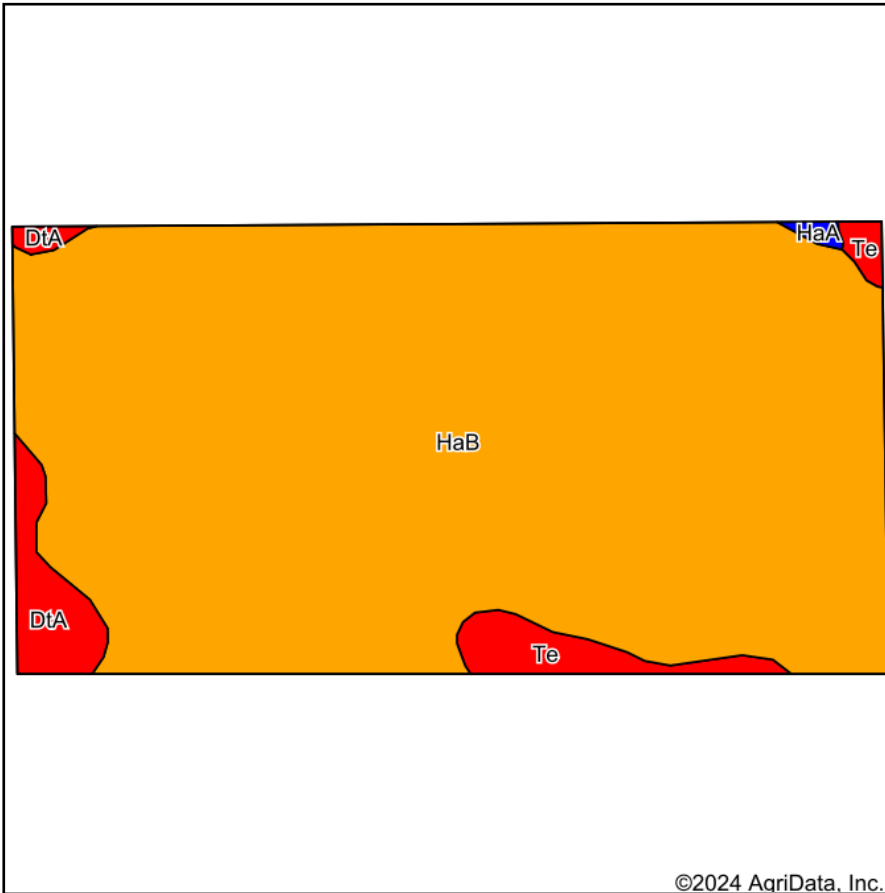



State: **South Dakota**  
 County: **Beadle**  
 Location: **15-112N-63W**  
 Township: **Broadland**  
 Acres: **80**  
 Date: **8/21/2024**

Maps Provided By:  
  
 CUSTOMIZED ONLINE MAPPING  
 © AgriData, Inc. 2023 [www.AgriDataInc.com](http://www.AgriDataInc.com)



Soils data provided by USDA and NRCS.

Area Symbol: SD005, Soil Area Version: 28

Code	Soil Description	Acres	Percent of field	PI Legend	Non-Irr Class *c	Productivity Index	Alfalfa hay Tons	Bromegrass alfalfa AUM	Corn Bu	Grain sorghum Bu	Oats Bu	*n NCCPI Soybeans	
HaB	Hand-Bonilla loams, 3 to 6 percent slopes	74.78	93.5%		Ile	79						62	
DtA	Dudley-Tetonka silt loams	2.57	3.2%		IVs	43	1.6	2.6	28	34	35	23	
Te	Tetonka-Hoven silt loams	2.44	3.0%		IVw	48						9	
HaA	Hand-Bonilla loams, 0 to 3 percent slopes	0.21	0.3%		Ilc	88						65	
<b>Weighted Average</b>						<b>2.13</b>	<b>76.9</b>	<b>0.1</b>	<b>0.1</b>	<b>0.9</b>	<b>1.1</b>	<b>1.1</b>	<b>*n 59.1</b>

\*n: The aggregation method is "Weighted Average using all components"

\*c: Using Capabilities Class Dominant Condition Aggregation Method